

HDH1525M

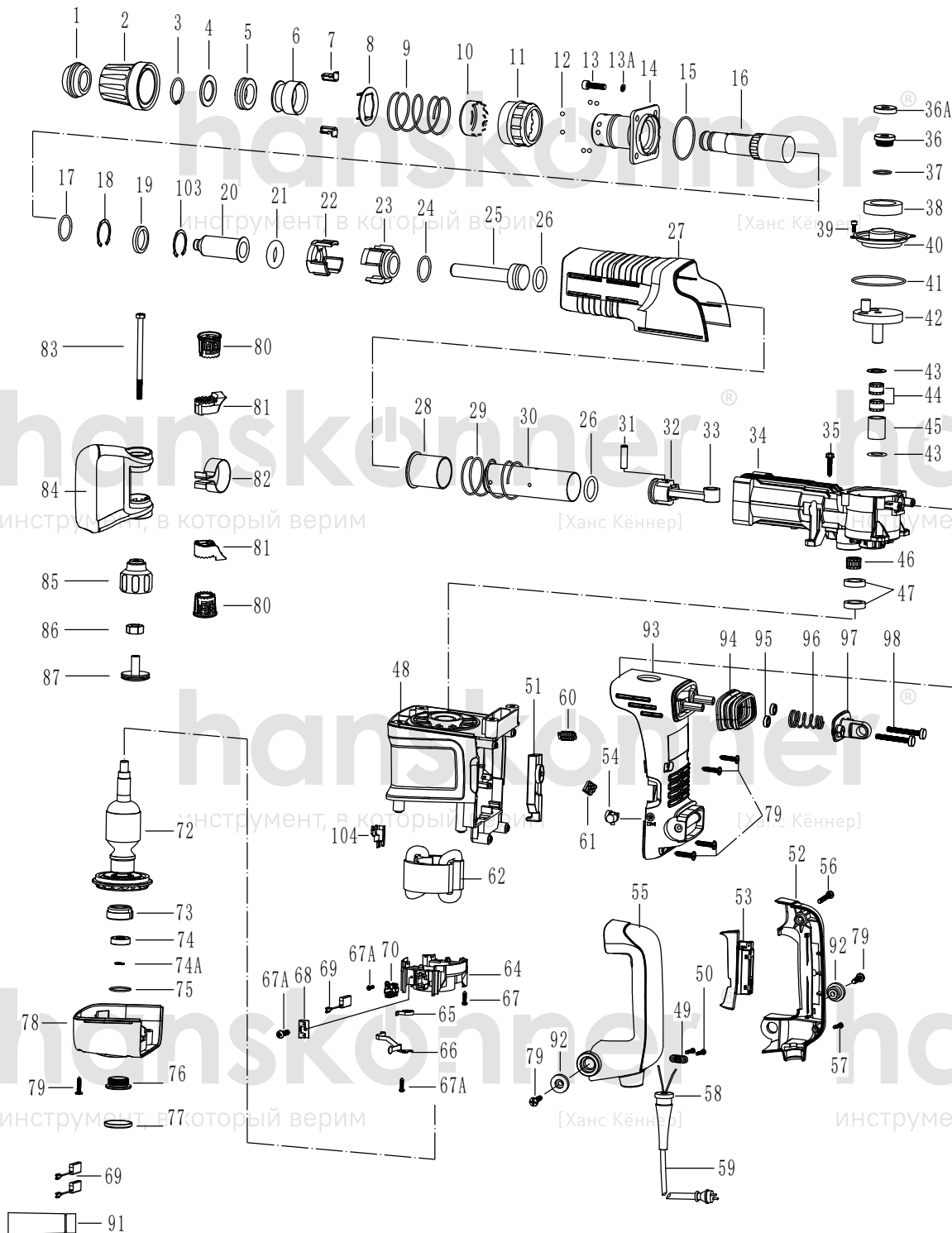

No.	Description	No.	Description
1	Hammer rod protector	51	Speed Adjuster (220-240V)
2	Protective lining	51	Speed Adjuster (110-120V)
3	Steel Wire Block Ring $\Phi 27 \times \Phi 2$	52	Main Handle Cover
4	Support patch	53	Switch
5	Shock absorption ring	54	Indicator
6	Move limited ring	55	Main Handle
7	Insert block	56	ST5.5x45 Tapping Screw
8	Change plate	57	ST4.2x22 Tapping Screw
9	Support ring spring	58	Cord Armor
10	Support ring	59	Cord
11	Move limited ring	60	0.18 μ H Electricity Feels
12	$\Phi 6.5$ Steel Ball	61	Rivet
13	Hex. Socket Bolt M8x30(12.9)	62	Stator 220-240V
13A	$\Phi 8$ Spring Washer	62	Stator 110-120V
14	Flange cover	64	Carbon Brush bracket
15	O-Ring $\Phi 63.5 \times \Phi 2.6$	65	Helical spring
16	Hammer rod sleeve	66	Metal contact plate
17	Fluorin O Ring $\Phi 31.6 \times \Phi 2.5$	67	Tapping screw ST3.5X16
18	$\Phi 41$ Retaining Ring	67A	ST3.5x12(8.8) Cross recessed pan head tapping screws
19	Oil Seal Ring $\Phi 32 \times \Phi 42 \times 7$	68	Metal insert
20	Impact Pin	69	Carbon Brush 220-240V
21	O Ring $\Phi 22 \times \Phi 11$	69	Carbon Brush 110-120V
22	Control plate	70	Carbon brush wire
23	Fixed Distance Sleeve	72	Armature 220-240V
24	O-Ring $\Phi 35 \times \Phi 3$	72	Armature 110-120V
25	Impact block	73	Bearing Sleeve
26	Fluorin O Ring $\Phi 30.4 \times \Phi 5$	74	6200 LUV Ball Bearing
27	Cover	74A	$\Phi 10$ Retaining Ring
28	Control Sleeve	75	O-Ring $\Phi 29 \times \Phi 2.6$
29	Control Sleeve Spring	76	Screw ring
30	Cylinder	77	Protected cover
31	Piston Pin $\Phi 10 \times 38$	78	Bearing Cover
32	Piston	79	Tapping screw ST5.5X25
33	Connecting Rod Ass'y	80	Disk with gap
34	Impact body	81	Clamping
35	Tapping screw ST6.3X32 (triplet)	82	Fixed belt
36	Oil Tank Cover	83	Hexagon head bolt M8x110
36A	Adorn Cover	84	Side Handle
37	Rubber Washer	85	Function Knob
38	Felt Ring	86	Nut M8(Thickness 6.4mm)
39	Hex. Socket Bolt M5x12	87	Function Knob cover
40	Shell cover	91	Oil Bottle $\Phi 35 \times 135$
41	O-Ring $\Phi 79 \times \Phi 2.8$	92	Main Handle Platen
42	Eccentric gear	93	Main Handle Seat
43	Boring washer	94	Shock Absorption Jacket
44	Needle Bearing RMAO16x22x16	95	Shock Absorption Ferrule
45	Needle Ferrule	96	Shock Absorption Spring
46	Needle Bearing NK20x28x13	97	Spring Rack
47	Seal ring subassembly	98	Cross recessed pan head screws M6x50($\Phi 18$)
48	Housing Ass'y	103	$\Phi 42$ Retaining Ring
49	Cord Clip	104	Stator Block
50	ST4.2x18 Tapping Screw		